

7. **U. T. Rio Grande Valley: Discussion and appropriate action regarding approval of the Campus Master Plan**

RECOMMENDATION

The Chancellor concurs in the recommendation of the Deputy Chancellor, the Executive Vice Chancellor for Academic Affairs, and the institutional president that the U. T. System Board of Regents approve the Campus Master Plan for U. T. Rio Grande Valley. A PowerPoint presentation is set forth on the following pages.

BACKGROUND INFORMATION

The Campus Master Plan mission, vision, and values will position U. T. Rio Grande Valley as a model of academic innovation for the distributed institution of the future. By leveraging existing locations, an enhanced bus rapid transit system, and digital connectivity, accessibility to regional, affordable, and high quality education will be maximized.

Core Priorities

The Master Plan uses the Texas Higher Education Coordinating Board calculation methodology to identify real estate needs. Using enrollment, research expenditures, and benchmarked growth targets to forecast real estate needs over the next 5, 10, and 15 years, building projects have been prioritized at U. T. Rio Grande Valley locations across the Valley.

Student Success

The Master Plan envisions physical and digital upgrades to existing locations that enable highly accessible, networked experiential learning, and student services across the Valley. Much needed enhancements to student unions, library, and recreation services will enrich the student experience.

Educational Opportunities

Over the next five years, enrollment growth will be absorbed through improvements in utilization and increases in online and hybrid learning. Regional accessibility will be broadened by renovations to significantly increase the use of existing Academic Hubs in Rio Grande City, Weslaco, and McAllen.

Research Impacting the Rio Grande Valley and Beyond

Existing research facilities, together with the new Medical Research Building at the Doctors Hospital at Renaissance campus in McAllen, will accommodate five to seven years of growth, but planned increases in research expenditures over 10 to 15 years will require significant space. New space will be decentralized across the Valley at strategic locations defined by the aligning four research themes: Health + Wellness, Innovation, Education, and Environment. These research themes will focus on critical needs relative to the Rio Grande Valley.

Health and Medical Education

The Master Plan envisions expansion of facilities at Harlingen as a major health sciences campus. Focusing growth in interprofessional learning and research, it will unite the Medical School with the College of Health Affairs. Expansion of the Ambulatory Interprofessional Medical Experience (AIME) sites will enable students to engage directly in community health and wellness programs region-wide.

Community Engagement

The increased use of the Academic Hubs and AIME locations to include wider programmatic offerings, economic development, and research programs will provide a network of places to facilitate increased community outreach, service learning, and partnerships.

Digital Connectivity and Bus Rapid Transit

Digital connectivity is considered a high priority for the Master Plan and future planning of the distributed campus model. The existing high-speed data/fiber network and planned substantial upgrades over the next five years at each of the campuses will meet current and future internet needs for teaching and research. It is intended that this will provide for remote teaching, video and streaming needs, and provide the level of connectivity required.

A bus rapid transit (BRT) network and supplementary shuttle system will provide interconnectivity to all three U. T. Rio Grande Valley campuses and Academic Hub locations throughout the Valley. The BRT service is scheduled to start in 2018.

2022	
1.	103K GSF Academic Building*
2.	55K GSF Multi-Purpose Building*
3.	50K GSF Library Renovation
4.	150K GSF Library
5.	75K GSF New Student Union
6.	75K GSF Support Services
7.	Central Plant Upgrades
8.	Duckhead Recreation Upgrades
2027	
9.	75K GSF Multi-Disciplinary Academic Building
10.	45K GSF Library Expansion
11.	New Central Utility Plant
2032	
12.	100K GSF Multi-Disciplinary Academic Building
13.	210K GSF Interdisciplinary Research Building
14.	100K GSF Recreation Center
15.	50K GSF Library Expansion
16.	60K GSF Support Services Building
17.	Student Housing

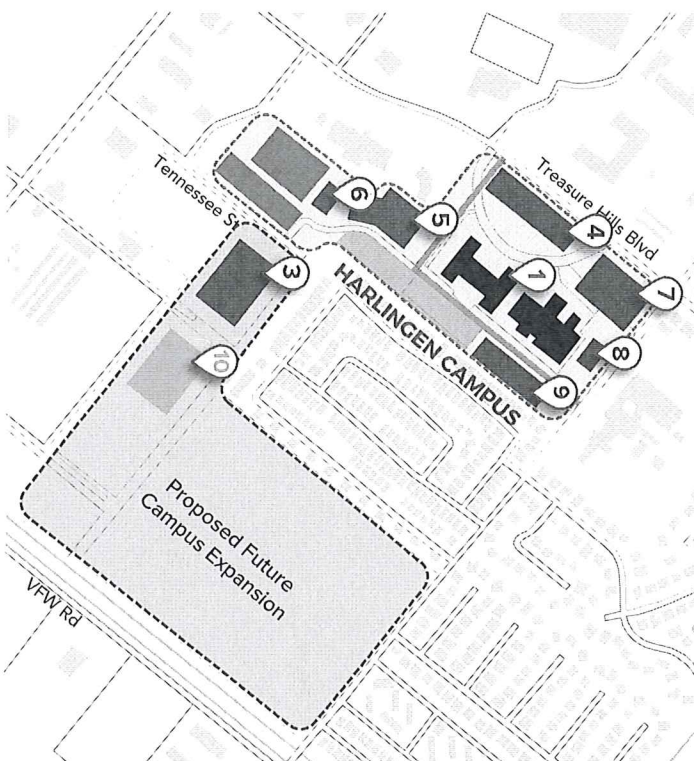
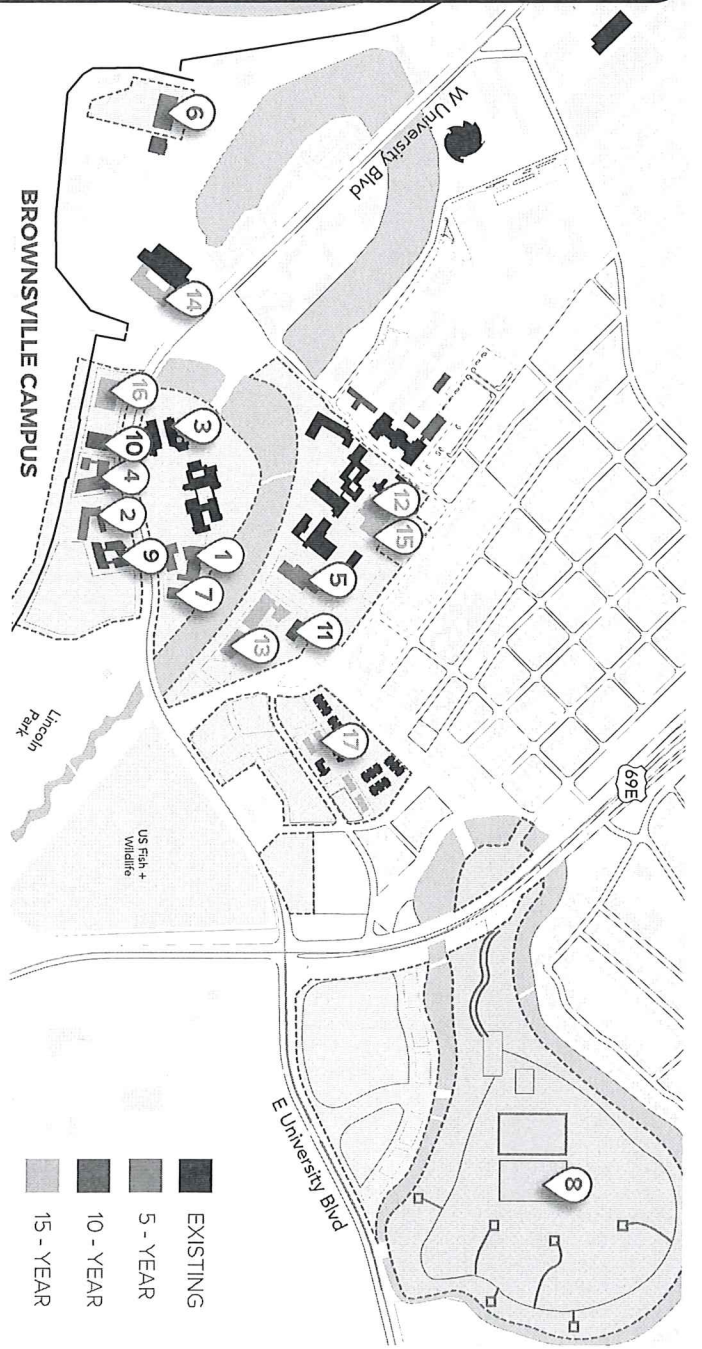

2022	
1.	99K GSF RAHC Renovation
2.	33K GSF University Center Renovation**
2027	
3.	130K GSF Health Sciences Research Building
4.	100K GSF Health Sciences Academic Building
5.	50K GSF Mixed Use Library + Recreation Expansion
6.	30K GSF Support Services Building
7.	Park + Ride / Transit Center
8.	New Central Utility Plant
9.	Student Housing
2032	
10.	100K GSF Academic Building and 50K GSF Library Expansion

Harlingen ▶

In conjunction with expanded use of the TSTC University Center, the Harlingen Campus will be expanded to become an integrated academic health sciences campus and a regional transit hub. Initial renovations will relocate Medical School and administrative offices to create expanded learning space for the School of Nursing. Later phases will include upgrades to the smart hospital, expansion of learning, library and support services, a new research building and housing.

* In construction | ** Not shown on map

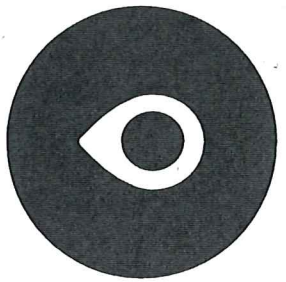

LOCATION

Edinburg ▼

At 2.5m sq ft, Edinburg is the largest of the UTRGV campuses. In updating the 2012 masterplan study to meet current and future projections we have followed its design guidelines which illustrated expansion to the north and west of the main campus and have projected new real estate development targets in the same locations. As illustrated below, the major change to the previous plan is in the speed and types of development. With academic growth being balanced across the UTRGV network, development on the Edinburg campus will initially be in library, student union, support, recreation and administrative facilities, followed by later developments for learning and research.

Brownsville ▼

The 2013 Brownsville Campus master plan suggested aggressive real estate development on newly acquired land. In updating it we have matched real estate development with new academic targets, lease space reevaluations, available land and upgrades to alleviate operational deficiencies. In following 2013 design guidelines we have maintained existing building locations, but adjusted the types and speed of delivery. With growth being balance across the decentralized UTRGV network, development at Brownsville will initially be in library, student union, support, recreation and administrative facilities. Expansion in learning and research will occur as growth targets are met in later years.

2022	
1.	109K GSF Science Research Building*
2.	55K GSF Interdisciplinary Engineering + Academic Studies Building*
3.	Central Utility Plant Upgrades
4.	150K GSF Library Renovation
5.	Student Union Expansion + Renovation
6.	75K GSF Support Services
7.	Intramural Fields Upgrades
2027	
8.	75K GSF Multi-Disciplinary Academic Building
9.	95K GSF Conference Center, Dining + Library Expansion
10.	New Central Utility Plant
11.	Schunior Street Expansion
12.	Van Week Street Pedestrian Corridor
2032	
13.	100K GSF Multi-Disciplinary Academic Building
14.	210K GSF Interdisciplinary Research Building
15.	50K GSF Wellness Center
16.	Recreation + Sports Fields
17.	Student Housing
18.	60K GSF Support Services
19.	Park + Ride / Transit Center

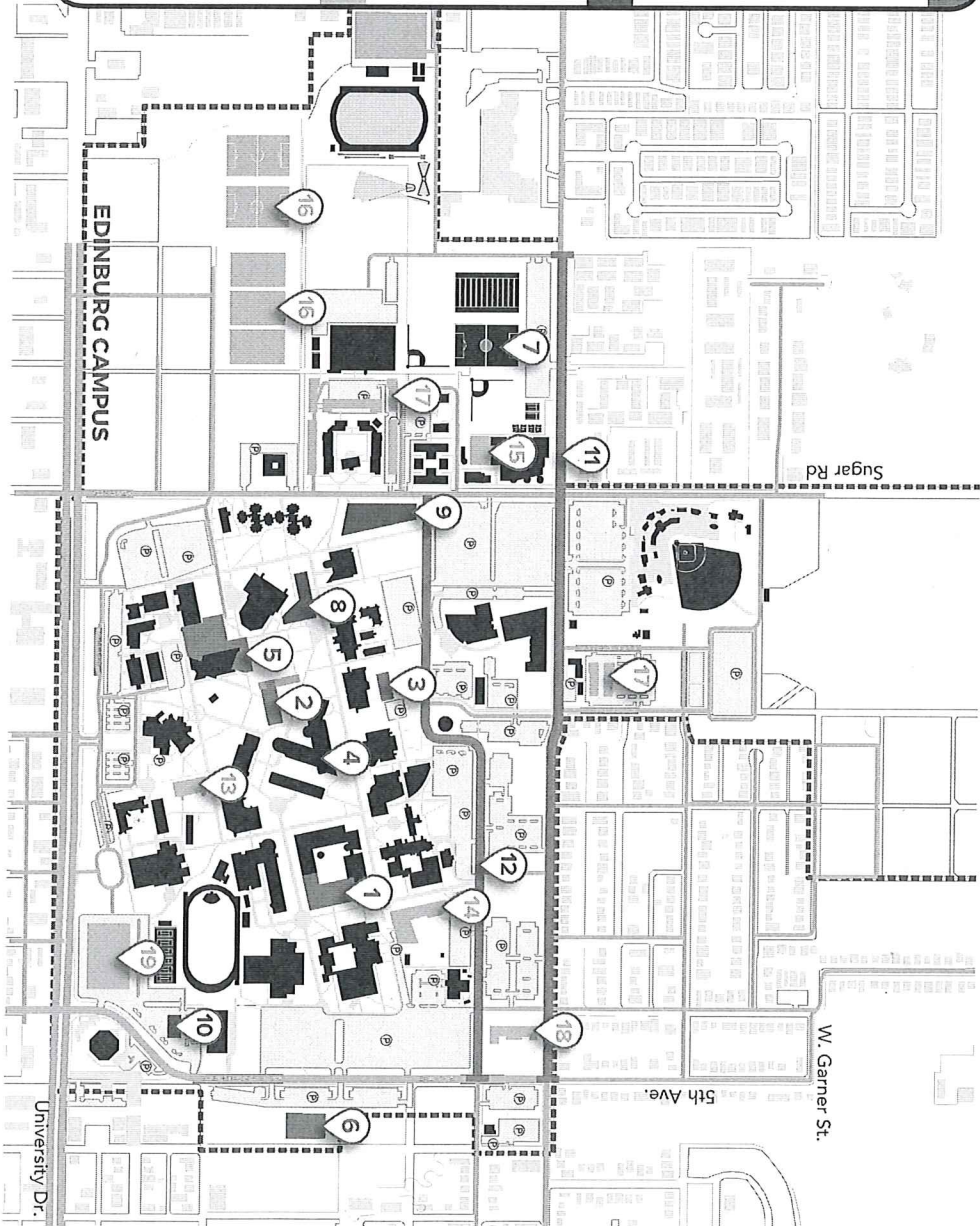

* In construction | ** Not shown on map